

View this email in your browser



Designing Buildings Wiki

The construction industry knowledge base

Featured articles and news

This week's featured article - BIM is big business

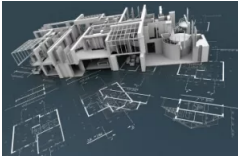

The global BIM market is expected to grow by 19% a year to reach US\$11.54 bn by 2022.

Ideas competition - Make Buildings Better

BSRIA and Designing Buildings Wiki are asking what your ideas are for improving the performance of buildings in use. Win £500 of BSRIA goodies.



Tratoppen, Stockholm

Concept designs have been published for Stockholm's tallest skyscraper.



Zero carbon homes

House of Lords seek to reintroduce zero carbon homes as part of the Housing and Planning Bill.



Unusual building of the week - Dali Theatre and Museum

The Dali Theatre and Museum, one of the 'largest surrealist objects in the world'.



Sustainable water

Bold change is required to deliver sustainable practice in the water sector.



Invoice fraud

UK construction businesses lose more than £1.6bn from invoice fraud each year.



Architecture and the need for innovation

Traditionally, architecture has evolved in line with technology, but how long will this continue?



Building of the week - Taj Mahal



Regarded as the finest example of Mughal architecture and one of the most beautiful buildings in the world.

Around the web

RICS, 28 April

What the EU referendum could mean for construction.

BSRIA, 28 April

BSRIA respond to concerns about 'airtight' modern homes.

BIM plus 28 April

Mott MacDonald launch BIM carbon calculator

FMB, 27 April

Salaries for small firms soar because of the growing skills shortage.

BBC, 26 April

Big Ben 'bongs' to be silenced for £29m repair work.

NHBC, 26 April

Report urges developers to recognise ageing population's needs.

Raconteur, 25 April

The world's most beautiful buildings.

BSRIA, 25 April

Study reveals the global cabling market declined in 2015.

The Guardian, 25 April

New homes are eroding the green belt at the fastest rate for 20 years.

The BIM, 22 April

Video explaining 'What happens if I don't do BIM?'

Construction Index, 22 April

Government statistics take too narrow a view of 'construction', according to CIOB.

Designing Buildings Wiki is supported by:

Rogers Stirk Harbour + Partners
Institution of Civil Engineers
BRE Trust
Buro Happold
U and I Group PLC
Chartered Institute of Building
BSRIA

Share Tweet Forward

